





DEDICATION CEREMONY

GARY A. RANDELL HALL

HOUSING THE COLLEGE OF EDUCATION
AND BEHAVIORAL SCIENCES

FRIDAY, APRIL 29, 2011
2 O'CLOCK IN THE AFTERNOON



THE WESTERN KENTUCKY UNIVERSITY BOARD OF REGENTS

JIM MEYER, CHAIR • YEVETTE HASKINS, VICE CHAIR • MELISSA B. DENNISON • FREDDIE HIGDON • COLTON JESSIE
JIM JOHNSON • JAMES KENNEDY • PATRICIA H. MINTER • J. DAVID PORTER, SECRETARY • ROB WILKEY • LAURENCE J. ZIELKE

DEDICATION CEREMONY

PRESENTATION OF COLORS
WKU ROTC COLOR GUARD

NATIONAL ANTHEM
MS. KATE DOUGLAS
LIBERAL ARTS MUSIC MAJOR

WELCOME
DR. SAM EVANS
DEAN, COLLEGE OF EDUCATION
AND BEHAVIORAL SCIENCES

REMARKS
REPRESENTATIVE JODY RICHARDS
KENTUCKY, 20TH DISTRICT

SENATE PRESIDENT DAVID L. WILLIAMS
KENTUCKY, 16TH DISTRICT

MR. ROBERT L. KING
REPRESENTING GOVERNOR STEVE BESHEAR
PRESIDENT, COUNCIL ON POSTSECONDARY EDUCATION

MR. JIM MEYER
CHAIR, WKU BOARD OF REGENTS

ACKNOWLEDGEMENTS
PRESIDENT GARY A. RANDELL

FANFARE AND CHORALE
MR. BENNIE BEACH, SR.
COMPOSER • FACULTY EMERITUS
WKU BRASS CHOIR
DR. GARY SCHALLERT, CONDUCTOR

STUDENT REFLECTIONS
MS. LAUREN B. MARTIN
EDUCATIONAL LEADERSHIP DOCTORAL STUDENT 2012

CLOSING
DR. EVANS

COLLEGE HEIGHTS
MS. DOUGLAS

GUTHRIE BELL TOWER
MR. NATHANIEL BROWN, CARILLONNEUR
ORGAN PERFORMANCE MAJOR

FANFARE AND CHORALE

THIS PIECE WAS ORIGINALLY COMPOSED FOR A 1964 CONCERT ON THE WKU CAMPUS.

TRUE PROGRESS IS NOT A GIFT – IT IS EITHER PARTLY OR COMPLETELY REALIZED IN DIRECT PROPORTION TO EFFORT, DESIRE, CREATIVE IMAGINATION AND TRUE DEDICATION. IN THIS WORK AN ATTEMPT HAS BEEN MADE TO CREATE TWO MOODS; ONE REPRESENTATIVE OF THE FORCES THAT CONSTANTLY IMPEDE PROGRESS; THE OTHER, REPRESENTATIVE OF THE FORCES THAT ASSURE A CONTINUING PROSPERITY.

THE FIRST MOOD IS ACCOMPLISHED THROUGH THE USE OF THE FANFARE – FORTISSIMO, BOLD, HARSH AND AGGRESSIVE; THE SECOND, THROUGH THE USE OF THE CHORALE – PIANISSIMO, SERENE, RESTRAINED AND REVERENT. THE CHORALE, SYMBOLIC OF PROGRESS, IS PURPOSELY UNFINISHED. IT IS PERIODICALLY INTERRUPTED BY FRAGMENTS OF THE FANFARE – SYMBOLIC OF LIFE’S OBSTACLES.

HOWEVER, THIS COMPOSITION ENDS IN A QUIET MOOD, INDICATIVE OF FINAL TRIUMPH.



STUDENT PARTICIPANTS

WKU ROTC COLOR GUARD

ALICIA CARVER
JORDAN CHICK
DANIEL COTTON

TIMATHY KLOTH
MICHAEL TERRY
JAKE VIERSTRA

WKU BRASS CHOIR

HORN: MADELYN COOK, DANIEL CRENSHAW, ELLYN KERCHENSKI, BRIT ROBERTS, DREW TUCKER

TRUMPET: CHRIS BLAKE, ANDY BURDEN, RYAN MEFFORD, PAUL ROTRAMEL, JOE STONE

TROMBONE: MATT CROCKER, SAM TINCH, MATT WHITE • BASS TROMBONE: CHARLES PRICE

EUPHONIUM: TAYLOR AKIN, HARRISON ASHLEY

TUBA: CHARLES JEWELL, GUYTANO MARTORANO, GRANT TURLEY

ABOUT WKU PRESIDENT GARY A. RANSELL

Gary A. Ransdell was named President of Western Kentucky University on September 12, 1997. He received his bachelor's and master's degrees from WKU in 1973 and 1974, followed by a doctorate in Higher Education from Indiana University in 1978. Dr. Ransdell came to WKU following his service as Vice President for Administration and Advancement at Clemson University in South Carolina. Prior to that, he served as Director of Alumni Relations at Southern Methodist University.

Dr. Ransdell is leading WKU through a transformation from a university of regional importance to a leading American university with international reach. WKU has been the fastest growing university in Kentucky for 13 straight years, with an enrollment increase of 44 percent from 14,500 to 20,900 students. Enrollment at WKU's three regional campuses in Glasgow, Owensboro, and Elizabethtown/Ft. Knox has grown to over 6,000 students, and WKU leads the state in the number of online degrees, courses, and distance learning students. WKU's graduation rate has increased by 33 percent, and the first year retention rate has grown by 15 percent. WKU completed its first capital campaign in 2003 with \$102 million in new gifts and pledges, and is nearing the completion of its second campaign with \$170 million in hand toward a 2012 goal of \$200 million. Sponsored research has also grown from \$11 million to \$30 million under Dr. Ransdell's leadership. The transformation of WKU also includes a rebuilding of the WKU campus with the completion of some \$500 million in capital construction since 1998 with nearly \$200 million of projects to be completed by 2012.

Major academic achievements include the creation of Kentucky's only independent Honors College; the establishment of the Gatton Academy of Math and Science in Kentucky; new baccalaureate degree programs in Electrical, Mechanical, and Civil Engineering; and new doctoral degree programs in Education and Nursing. Internationalization of the WKU experience has been highlighted by significant growth in study abroad programs; numerous student, faculty, and research exchange programs with international universities; and new partnerships with Hanban in Beijing, China, for Kentucky's first Confucius Institute; the University of Evansville at Harlaxton College in Grantham, England; and an agreement with Navitas to facilitate international recruitment.

Dr. Ransdell serves as Chair of the Board for the Louisville Branch of the Federal Reserve Bank of St. Louis.

Gary and Julie Ransdell met as WKU students and married in 1972. They have 2 sons—Patrick (WKU '02) and Matthew (WKU '06), who both played baseball for WKU, and a daughter-in-law—Brooke (WKU '04), and a grandson—Walker (WKU Class of 2029!). They also have two Labrador Retrievers named Topper and Spirit and a Rhodesian Ridgeback named Tsavo!

Dr. Ransdell has an agreement with the Board of Regents to serve as WKU President through 2022.



ABOUT GARY A. RANSELL HALL AND THE COLLEGE OF EDUCATION AND BEHAVIORAL SCIENCES

Gary A. Ransdell Hall is designed to exceed the requirements for Leadership in Energy and Environmental Design (LEED) certification. LEED is an internationally recognized green building certification system, providing third-party verification that a building or community was designed and built using strategies aimed at improving performance across all the metrics that matter most: energy savings, water efficiency, CO2 emissions reduction, improved indoor environmental quality, and stewardship of resources and sensitivity to their impacts. (www.usgbc.org)

The College of Education and Behavioral Sciences is housed in Gary A. Ransdell Hall at Western Kentucky University. The history of the college is intertwined with the history of the university. In 1906 the Kentucky General Assembly approved legislation to establish two teacher training institutions, or “normal schools,” in the state. Western Kentucky State Normal School was created, and its focus of teacher training and certification has served as the basis for the current College of Education and Behavioral Sciences at Western Kentucky University.

The College of Education and Behavioral Sciences is home to six academic units: the Departments of Counseling and Student Affairs, Educational Administration, Leadership and Research, Military Science, and Psychology; the School of Teacher Education; and the Doctor of Education (EdD) program. In addition, the college houses several centers of excellence, including The Center for Gifted Studies and the World Council for Gifted and Talented Children; the Center for the Study of Lifespan Development; the Center for Environmental Education and Sustainability; the Center for Literacy; the Center for Learning Excellence; the Center for Excellence in Teaching and Learning, Models in Innovation; and the Center for STEM Education Initiatives. Through the Suzanne Vitale Clinical Education Complex, faculty members and students in the college, along with colleagues across campus, provide services through the Kelly Autism Program and the Talley Family Counseling Clinic.

VISION: Leaders in Scholarship and Innovation

MISSION: Empowering individuals to lead and serve our dynamic world

COLLEGE OF EDUCATION AND BEHAVIORAL SCIENCES HIGHLIGHTS

- ▶ The CEBS offers nine undergraduate majors and three undergraduate minors.
- ▶ Elementary Education is the largest undergraduate major at WKU.
- ▶ Library Media Education is the largest graduate major at WKU.
- ▶ The EdD in Educational Leadership was the first stand-alone doctorate at WKU. There are 135 students admitted to one of four strands: P-12 Administrative Leadership, Teacher Leadership, Postsecondary Leadership, and Organizational Leadership.
- ▶ The CEBS has the largest graduate enrollment of all WKU colleges.
- ▶ CEBS programs are accredited by the National Council for Accreditation of Teacher Education, the Council for Accreditation of Counseling and Related Educational Programs, the Department of the Army, and Kentucky's Education Professional Standards Board; and nationally recognized by the American Association for School Librarians and the National Association for School Psychologists.
- ▶ In Spring 2011 there were 19 students completing part of their student teaching experience in an international setting, including placements in Spain, Germany, and Equador. In recent semesters students also have completed student teaching assignments in Belize and Mexico.
- ▶ As home to one of the largest Reserve Officers' Training Corps in the nation, WKU Army ROTC's Hilltopper Battalion received the prestigious 2011 MacArthur Award.
- ▶ The World Council for Gifted and Talented Education relocated its headquarters from Canada to WKU in January 2011, and is now housed in Gary A. Ransdell Hall.
- ▶ Four students in the Student Affairs graduate program recently placed first in a national virtual case student competition, competing against 36 teams from 24 institutions.
- ▶ The CEBS offers 22 graduate degrees, six graduate certificate programs, and 15 graduate-level certification programs.
- ▶ The undergraduate program in Psychology is the fifth largest at WKU and one of the fastest growing.
- ▶ The Department of Counseling and Student Affairs offers unique certificate programs in International Student Services, Career Counseling, and Addictions Counseling and Education.
- ▶ The first five graduates of the EdD program will be hooded at the May 2011 commencement.
- ▶ The CEBS has seven University Distinguished Professors: five in the Department of Psychology and two in the School of Teacher Education.
- ▶ Each year WKU graduates approximately 400 new teachers and recommends more than 1,000 individuals to the state for professional education credentials. More of Kentucky's education professionals earned a degree from WKU than from any other institution.
- ▶ In 2008 WKU was a recipient of the Christa McAuliffe Award for excellence in college and university teacher education programs.
- ▶ Since 2000 four Psychology faculty members have won the university faculty award for excellence in research and creative activity. Only one university department has had more research award winners than Psychology.
- ▶ Fourteen of the current EdD students have included international travel in their program of studies, visiting China, France, Malaysia, and Spain.
- ▶ The Kelly Autism Program at the Suzanne Vitale Clinical Education Complex provides services and support to adolescents and young adults diagnosed with an autism disorder, as well as to their families. Some KAP services have been made available in Owensboro as well as in Bowling Green.

- ▶ The Department of Educational Administration, Leadership, and Research has been a partner since 1998 in the Administrative Leadership Institute to provide a unique training program for aspiring minority school administrators in Kentucky. WKU has provided course work for Level 1 Principal certification and other professional development experiences.
- ▶ In 2010 the Department of Military Science began offering one of only three baccalaureate programs nationwide in Military Leadership.
- ▶ WKU recently received a \$500,000 Toyota USA Foundation Award that will help fund the Math and Technology Leadership Academy.
- ▶ WKU alumna Patrice McCrary was inducted into the National Teachers Hall of Fame in 2009.
- ▶ Psychology has the largest number of full-time graduate students in the university.
- ▶ In 2009 WKU's Center for Gifted Studies was awarded a \$2 million grant by the U.S. Department of Education for Project GEMS (Gifted Education in Math and Science).
- ▶ The CEBS, along with Ogden College of Science and Engineering and the Jefferson County (Ky) Public Schools, received a 2010 U.S. Department of Education grant to offer "GSKyTeach," a residency program to prepare college graduates with math and science degrees to become teachers in high-need schools.
- ▶ WKU teacher education students achieved a 97% pass rate in the most recent report of scores on the required standardized tests for teacher certification.
- ▶ In the past year the faculty in the Department of Educational Administration, Leadership, and Research have completed a redesign of their program to prepare school principals. Among several unique features are its cohort design, its strong field component (with 30 hours of field work required in every 3-hour course), and the requirement for all admitted students to have previously completed a master's degree.
- ▶ WKU is home to the Gov. Louie B. Nunn Kentucky Teacher Hall of Fame.
- ▶ The Center for Gifted Studies offers summer programs for gifted and talented middle and high school-age youths. Alumni of these programs have gone on to great success and include at least three Rhodes Scholars, three Truman Scholars, two Fulbright Scholars, and six Jeopardy winners.
- ▶ In 2009 WKU received a National Science Foundation grant of nearly \$900,000 that will benefit SKyTeach, WKU's innovative program to develop more and better-prepared science and mathematics teachers.
- ▶ WKU offers several fully online graduate programs including Library Media Education, Special Education, Elementary Education, Adult Education, Literacy Education, and Instructional Design. Many others are offered in blended formats that include delivery via the Web and video, as well as face-to-face.
- ▶ During Spring 2011 the Center for Environmental Education and Sustainability sponsored "Project Rain Barrel," in which environmental education students have recycled Pepsi syrup barrels into rain barrels to be used in storm water management.
- ▶ The Center for Literacy provides support for the College Reading Success program that helps WKU undergraduates develop and enhance reading comprehension skills to help them succeed in other courses.
- ▶ The Talley Family Counseling Clinic at the Suzanne Vitale Clinical Education Complex offers affordable counseling services for individuals and families in need. In addition, the FCC provides support for research activities and training opportunities for graduate students in the Department of Counseling and Student Affairs.
- ▶ Since 1995 100% of School Psychology graduate students have passed the national exam required for school psychology certification.
- ▶ Each year the CEBS hosts the Mary E. Hensley Lecture Series, the Boyd-Lubker Visiting Scholars Program, and the Wedge Visiting Professorship.

COLLEGE HEIGHTS

Mary F. Bradley, 1930
arr. John Martin, 2002

Voice



Col - lege Heights on hill - top fair with beau - ty all thine own,
Col - lege Heights with liv - ing soul and pur - pose strong and true,
Col - lege Heights thy no - ble life shall e'er our pat - tern be,

5



love - ly jew - el far more rare than grac - es an - y throne. Col - lege Heights,
serv - ice ev - er is thy goal, thy Spir - it ev - er new.
teach - ing us through joy and strife to love hu - man - i - ty.

10



We hail Thee, We shall nev - - er fail Thee,

16



falt - er nev - - er, live for ev - er

21



Hail! Hail! Hail!

GARY A. RANSELL HALL

LEGEND

- classrooms / auditorium
- educational resource center
- school of teacher education
- dean's office / teacher services office
- counseling & student affairs offices
- psychology offices & research labs
- educational administration leadership & research offices
- educational technology center offices
- clinic
- circulation
- support spaces

FIRST FLOOR

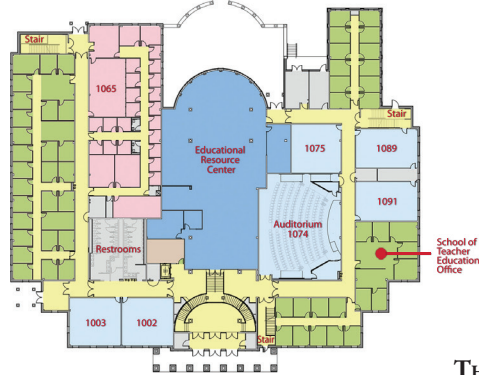

SECOND FLOOR

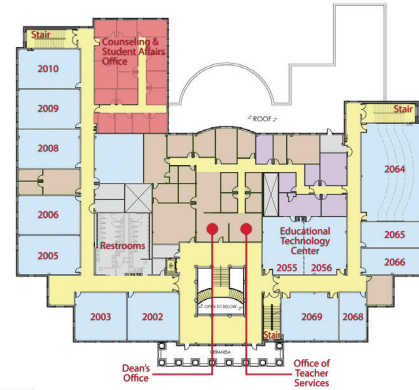

THIRD FLOOR

